



# Friends of the Forest

*Dedicated to the preservation of the Anacortes Community Forest Lands through education, outreach & stewardship*

Volume 28 • Issue 2 • Spring 2014

## Saving South Mt. Erie

### INTRODUCING THE SOUTH MT. ERIE (UDD PROPERTY) CAPITAL CAMPAIGN

We have a rare opportunity to add 20 acres on south Mt. Erie with high recreational and conservation value to the ACFL. The Friends of the Forest are partnering with the City on this capital campaign.

The City has signed an option to purchase land on the south side of Mt. Erie from the Udd family at the appraised price of \$260,000. As you can see on the attached map, the land abuts the ACFL on two sides and covers a significant area of the south side of Mt. Erie up to the 700' elevation level. We believe the land was logged early last century, but now has a mix of second growth forest amid meadows and rocky bluffs. The land also hosts a section of the south Mt. Erie trail which is a popular route used by hikers and bicyclists that has beautiful views of Skagit Bay and south Fidalgo.

The City of Anacortes has committed to spending \$130,000 of quarry revenues to exercise this purchase option. In order to reserve funds for potential future acquisitions to the forest lands, we are reaching out to the community to help us purchase the Udd acreage. The City is asking local donors to help raise \$130,000 to buy the land, plus an additional \$20,000 to help fund the conservation and stewardship of the land in the future. This purchase option is valid until December 2014, so please do not wait.

You can make an electronic donation on the Friends of the Forest website, or mail a check made out to the city or the Friends. Please make your donation clearly labeled with South Mount Erie Capital Campaign or Udd Property written in the note section on your check.

Please use this address:

**Friends of the Forest,  
PO Box #2213, Anacortes WA 98221**

Our physical address at The Depot does not have a mailbox. Thank You!

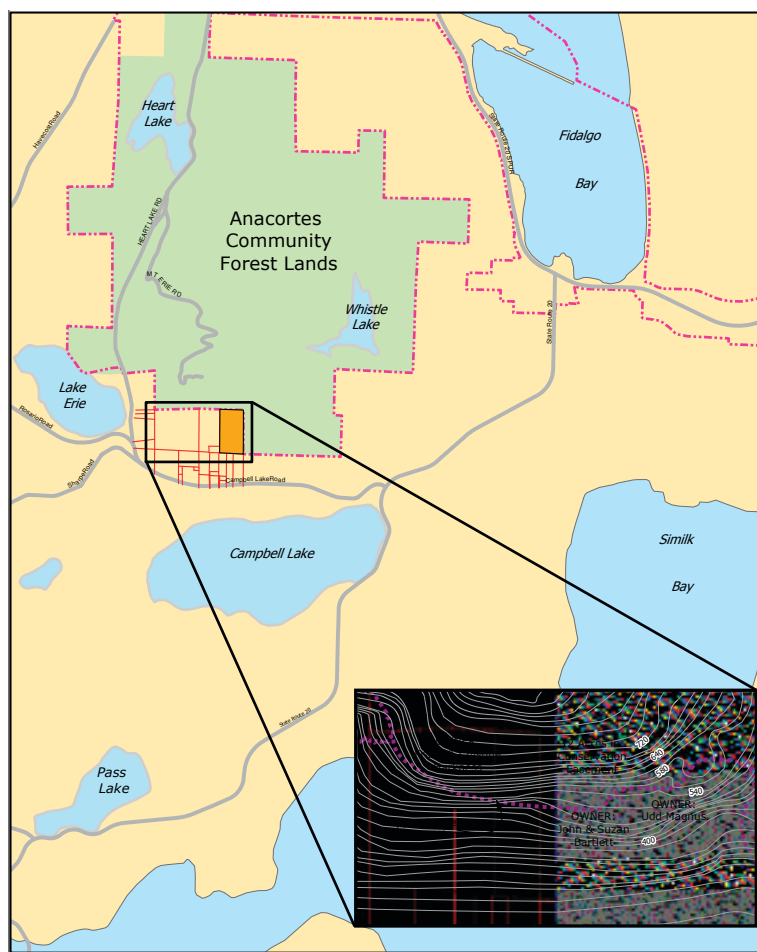

0 0.25 0.5 Miles

**South Mt. Erie  
Landowners**

Aerial Photo July 2011  
March 2014

We are very excited and hope that a successful campaign will help in the long term effort to conserve other sensitive forested private lands adjacent to the ACFL. Please join in this opportunity we've all been waiting for!

# ACFL Maintenance Report:

## MARCH - 2014

by Dave Oicles

Much of March was spent clearing trails from the February 22nd Storm. For 3 weeks I pretty much just operated a chainsaw to clear the hundreds of trees and large limbs off the trails. There are still a lot of small limbs on many of the trails, but as far as I know every trail is now open. I was very fortunate to have many volunteers respond to my outreach for help in clearing debris off the trails. Anacortes has some of the best volunteers and the response to help out allowed the trails to open in 3 weeks instead of 3 months. It was awesome and much appreciated. I would like to especially thank Volunteers Bruce Rustad, Kenny Schimke, Nick Stowe and Carolyn Moulton of BikeSpot, Kevin Foss and the Fidalgo Trail Riders, "Big Ed" Clausen, Lorne Shao, Dan Senour, Karen Shepard, and USFS certified chainsaw cutters Len Francies and Peter Partel from Seattle for all their extra time spent in the ACFL to reopen our trails for everyone to enjoy. You guys rock! I've attached a few photos of the event...



A successful Work Party was held on March 8th to clear trails of downed limbs & trees.

Thank you to Kevin Foss, Sue Wintermantel, Garth Wilson, Sky Guthrie, Keegan Janicula, Derek Chase, Rachel Foss, Ethan Foss, Ed Clauson, Josh, Maryn, & Liv Bates, Matt & Ian Lujan, Leonard Francies, Peter Partel, John, Eli, and Mica Gold, and Eric Olsen for all your help!



### ***South Mount Erie Harkness Property Update***

We were holding the presses with the intent of giving you the latest information regarding the Harkness Property on the Southwest slope of Mount Erie. The latest news as we now go to press is that the Skagit County Hearing Examiner has delayed a determination again, this time until April 21st to allow for the submission and review of more information. In our fall issue we reported that Evergreen Islands had appealed the County's issuance of a Mitigated Determination of Non-Significance on a forest practice conversion application (PL 13-0102 and grading permit application (BP-13-0136) filed by Mr. Frank Harkness. Mr. Harkness proposed to harvest the timber on the subject site, construct an access road, and develop the 40 acre parcel for residential purposes.

Since that time, the Hearing Examiner sent the parties to legal mediation to try to come to an agreement. City staff was also in attendance. Mediation failed to bring the parties to a mutually agreed solution, and it has gone back to the Hearing Examiner for further review and issuance of decision.

A concurrent factor is that Mr. Frank Harkness has simultaneously applied for a Forest Practices Application (including additional updates) with the Department of Natural Resources, a process that would provide a timber harvest option and possible development without county review.

The trail that crosses the property has been fenced off; please do not try to access it at this time. We are hopeful that an amenable solution will still be found that provides for conservation of the sensitive upper reaches of the property and continuing recreational access.



# Crowe's Nest

Spring 2014



The bright greening of the forest has begun, and Spring is truly here. We have Forest Education Programs scheduled in every available window of student time from the end of Spring Break

until the last week of school. Third grade students will be continuing their native plant studies from the fall through our Growing Wild Program, and seventh grade students will be delving into the Island Watershed through our Watershed Discovery Program.

High School Students have had the opportunity to be involved throughout the year through a variety of Green Club Activities. I have had the pleasure of working with them on an invasive species removal project on the high school campus. Students identified the problem of invasive species growth on school grounds, and created a map of the worst areas and dominant plants in those areas. They consulted with District staff, and together we prioritized our effort and goals for each area. I helped train them in plant identification and best removal practices, and have been a primary guide during work parties. Ranger Dave Oicles has been kind enough to lend tools and expertise as well. We have focused our efforts on a Scotsbroom filled hillside above the track and field complex, where removal helps control the seed production that makes its way to the forest and serves the dual purpose of increasing visibility and seating for sports fans. The students have taken great pride in their work, and everyone has learned more about the importance of active invasive species control for the long term health of all of our island's natural areas. In addition to Green Club, I was able to host three seniors for job shadow days this school year and we are excited for our growing scholarship program. If invasive species control in the forest is an area of interest for you, and you've got some time to give- let us know! We have an ongoing effort that needs all the help it can get.



Hope to see you in the woods,

*Denise Crowe*



# Spring Calendar 2014

*Get to know your community forestlands! It's time to join a guided hike, and begin to learn more about the fascinating wild heart of our island.*

The Friends of the Forest is a non-profit, citizen organization dedicated to the preservation of the Anacortes Community Forest Lands through education, outreach, and stewardship. We have a multi-layered education program that strives to meet the needs of all Fidalgo Island residents. Our education program includes K-12 guided school field trips, Adult/Senior hikes, All ages hikes, Forest Discovery Day Camp, stewardship opportunities, Ethnobotany field seminars, a quarterly newsletter, and our two comprehensive school district programs; Growing Wild-native plants for all 3rd graders, and Middle School Watershed Discovery for all students in the 7th grade.

Our community hikes are FREE and no registration is required. Please join Naturalist, Denise Crowe, this spring as we continue to explore and learn more about the ACFL together. For more information about our group or these hikes please contact Denise Crowe or Jean Andrich at 293-3725. You may also visit our website [www.friendsoftheacfl.org](http://www.friendsoftheacfl.org) or inquire by email at [info@friendsoftheacfl.org](mailto:info@friendsoftheacfl.org). These activities focus on human and wildlife experience, so we ask that you please leave your dogs at home. Hope to see you in the woods!

## All Ages Hikes

Great for families and folks of all ages, these are hearty hikes averaging 2-3 miles with a naturalist guide.

**Little Cranberry Lake**  
**Saturday, April 26th**  
**10am until noon**

We'll start the spring wildflower season with a hike all the way around Little Cranberry Lake. The trail is rugged in places as it hugs the shore. Rocky meadows will be awash in wildflower color, while native berry shrubs will be loaded with fertile bloom and the buzz of friendly bumblebees. Explore some of the richest habitat in our forest. This is the place where deep forest, swamp, rocky meadow, lake, and bog islands converge. Take Georgia south off of Oakes and follow to the gravel road that leads to the Little Cranberry Lake parking lot.

**Sugarloaf Wildflowers**  
**Saturday, May 10th**  
**10am until noon**

This is the ultimate wildflower hike of the year. We will savor the climb through alternating forest and rocky bald meadow, learning each flower as we go. From blue camas lily to red Indian paintbrush, come and see the bounty of color this little mountain has to offer. The views from the summit are not to be missed. Meet at the Southern trailhead halfway up the Mount Erie view road. The trip up and back is one mile, and quite steep in places.

**Whistle Morning**  
**Saturday, May 31st**  
**10am (estimate 3 hours)**

Whistle Lake territory is worth the extra time it takes. We will hike all the way around the coldest, deepest jewel of the forest. Meet at the Whistle Lake parking lot.

## Senior/Adult Hikes

A little bit gentler and just around two miles, with an adult level flora and fauna focus...

**Northwest Whistle Lake**  
**Friday, May 9th**  
**10am until noon**

Lush Spring growth will be at peak as we hike in to Whistle Lake. Do you know thimbleberry, huckleberry, salmonberry, elderberry, Oregon grape, salal? Do you know the difference between our native blackberry and Himalayan blackberry? The glimmer of the clearest lake on Fidalgo will be your lesson's reward. Bring a friend! Meet at the Whistle Lake Parking lot at the end of Whistle Lake Road.

**Heart Lake Old growth Loop**  
**Friday, June 20th**  
**10am until noon**

It's time for a visit with our elders on the south shore of Heart Lake. Orange trumpet honeysuckle and Ocean spray will be blooming as we slow to the ancient rhythm of our old growth forest. Meet at the base of Mount Erie on Ray Auld Drive.



**ETHNOBOTANY FIELD SEMINAR**  
**Friday, June 27th • 10am until 3:30pm**

Adults only, must register by phone or email. More information will be provided upon registration. Give yourself a day of slow paced forest exploration with naturalist Denise Crowe. Get to know the amazing history and characters of the plants of our island. Ethnobotany is the study of native plants and the traditional uses of the plants by people. You will learn about food, medicine, and materials derived from the vast array of native plants in our woods.



Early spring brings magenta Salmon Berry blooms.



Alder Catkins are more subtle, but their beauty is revealed if one looks closely.

**Spring Adult Fitness Hike - For the very fit!**

**Saturday, May 17th**  
**10 am until 1 pm**

Join Board Members Scott, Monica and Jean for a challenging and fast paced adventure. Prepare to cover 8 miles of trail on this three hour tour of Little Cranberry terrain. Bring water and a snack. Meet at the Little Cranberry Lake parking lot. Take Georgia south off of Oakes and follow up to the ACFL road, take a right and follow to the parking lot.

***Save the date!***

**Forest Discovery Program 2014**

Session 1 – July 22, 23 and 24 • Session 2 – August 5, 6 and 7

This is an activity oriented summer day camp for boys and girls ages 7 to 12. Each day we explore a different area of our Anacortes Community Forest Lands. For more information, contact Jean at 360.293.3725 or [jean@friendsoftheacfl.org](mailto:jean@friendsoftheacfl.org)

# WAYS TO GIVE

Our work depends on a healthy mix of funding sources. All contributions to our group are tax deductible. Please consider the following options for financial contribution to our organization.

## 1. Active Membership

Dues are due in January! There are different categories of membership to suit your preference. Any contributions to our group above your membership level are greatly appreciated. See our membership form on the back page.

## 2. Individual Contributions

We greatly appreciate any contributions to help support our education and outreach program. You can make these in honor or in memory.

## 3. Friends of the Forest Endowment Fund

We have an endowment fund established with the Skagit Community Foundation. The purpose of this fund is to create an endowment that will eventually provide interest income to our organization. This is an excellent option for sizeable donations to our group.

## 4. Planned Giving

If you are making estate plans, please consider including our organization.

You may contact Denise Crowe or Jean Andrich (360-293-3725) at our office to discuss any of these options.



## Membership Notes

January starts the new membership year, regardless of what month you joined or renewed.

To save resources, we do not send out reminder postcards. Please renew or join today!  
Confused on a hike location? Check out our website for links to driving directions to each hike location.



Our regular office hours are Tuesdays, Wednesdays and Thursdays from 10 am to 1 pm and always by appointment.

Need an ACFL trail map? We have them for sale in our office or you may also visit our website for a complete list of local sources. [www.friendsoftheacfl.org](http://www.friendsoftheacfl.org) / [info@friendsoftheacfl.org](mailto:info@friendsoftheacfl.org)

## FOREST ADVISORY BOARD

The City Forest Advisory Board meets every first Thursday of the month at 7:00pm at Fidalgo Center and is open to the public.

## CITY OF ANACORTES ELECTED OFFICIALS

Meetings are 1st and 3rd Mondays, 7:00pm in Council Chambers.  
Study Sessions are 2nd and 4th Mondays, 7:00pm in Council Chambers.

### FOREST BOARD MEMBERS

Sandra Starbuck 901-9179  
Brian Wetcher 293-7624  
Marty Laumbattus 293-7940  
Rick Boge 299-2692  
Aaron Ramussen 293-3018

### PARKS & FOREST LANDS

#### MANAGER

Jonn Lunsford 299-1953

NAME	E-MAIL	PHONE	TERM ENDS
Mayor Laurie Gere	<a href="mailto:coa.mayor@cityofanacortes.org">coa.mayor@cityofanacortes.org</a>	299-1950	12/31/17
W1 Ryan Walters	<a href="http://www.ryanwalters.org">www.ryanwalters.org</a>	610-7770	12/31/15
W2 Brad Adams	<a href="mailto:brada@cityofanacortes.org">brada@cityofanacortes.org</a>	293-3056	12/31/15
W3 Eric Johnson	<a href="http://www.anacorteseric.org">www.anacorteseric.org</a>	840-5415	12/31/15
P-4 Matt Miller	<a href="mailto:mattm@cityofanacortes.com">mattm@cityofanacortes.com</a>	588-9070	12/31/17
P-5 John Archibald	<a href="mailto:john@cityofanacortes.com">john@cityofanacortes.com</a>	395-5923	12/31/17
P-6 Liz Lovelett	<a href="mailto:lovelettl@cityofanacortes.com">lovelettl@cityofanacortes.com</a>	588-8707	12/31/17
P7 Erica Pickett	<a href="mailto:ericap@cityofanacortes.org">ericap@cityofanacortes.org</a>	293-6264	12/31/17

Mayor, 4-year term, at large, salaried - 299-1950  
Council Members (7) 4-year terms - 3 from Wards, 4 at Large - 293-1900

## FRIENDS OF THE FOREST

### OFFICERS

President Andy Stewart 299-9406  
Vice President Monica Ochs 293-6003  
Secretary Bill Dietrich 588-0118  
Treasurer Lin Nichols 299-3826

### EDUCATION AND OUTREACH DIRECTOR

Denise Crowe 293-3725

### ADMINISTRATIVE DIRECTOR

Jean Andrich 293-3725

### WEBSITE ADDRESS

[www.friendsoftheacfl.org](http://www.friendsoftheacfl.org)

### BOARD MEMBERS

Andy Stewart	299-9406	Jan. 2016	<a href="mailto:akccstewart@earthlink.net">akccstewart@earthlink.net</a>
Jean Andrich	293-0124	Jan. 2016	<a href="mailto:jean@friendsoftheacfl.org">jean@friendsoftheacfl.org</a>
Lin Nichols	293-3826	Jan. 2016	<a href="mailto:lin.nichols@yahoo.com">lin.nichols@yahoo.com</a>
Monica Ochs	293-6003	Jan. 2016	<a href="mailto:monica.ochs@gmail.com">monica.ochs@gmail.com</a>
Bill Dietrich	588-0118	Jan. 2016	<a href="mailto:williamdietrich@comcast.net">williamdietrich@comcast.net</a>
Denise Crowe	293-8426	Jan 2015	<a href="mailto:denise@friendsoftheacfl.org">denise@friendsoftheacfl.org</a>
Scott Gudmundsen	293-1550	Jan 2015	<a href="mailto:robertgudmundsen@shell.com">robertgudmundsen@shell.com</a>
Charlie Collins	873-8873	Jan 2015	<a href="mailto:troutdental@yahoo.com">troutdental@yahoo.com</a>
Ed Gastellum	293-7626	Jan 2015	<a href="mailto:ecgastel@wavecable.com">ecgastel@wavecable.com</a>

Friends of the Forest Board Meetings are at 7pm the second Wednesday of each month. We meet in the Depot Building, located at 611 R Avenue, Anacortes. Meetings are open to the public. Please come and get involved.

# Thank you to Friends of the Forest 2014 Members and Contributors!

Kym & Roger Aasen  
 Evelyn & Gary Adams  
 Ramin Ahsaei  
 Kathryn Alexandra  
 Kerry Allen  
 Terry & Janice Altomari  
 Debbie Amos & Phil Cohen  
 Sandra Anderson  
 Bret & Jean Andrich  
 Bruce Baglien  
 Jeff & Denise Bauman  
 Helen Baumgartner  
 Beth Bell  
 Paul Benz  
 Beverly & Mark Beppler  
 Richard Bergner  
 David Grant Best  
 Patrice & Phil Blakeway  
 Ray & Carolyn Bloom  
 Loren & Teresa Bogart  
 Marcia & Lester Books  
 Jackie Boss  
 Larry & Shirley Bowlin  
 Ann & Jon Bowman  
 Judy Bown  
 Robert & Michele Brechlin  
 Paul & Mary Brower  
 Jeanie Browne  
 Joost Businger & Marianne Kooiman  
 Donald & Stacey Campbell  
 Betty Carteret & Eric Shen  
 Kathryn Cavit & Morty Cohen  
 Mary & Harry Chandler  
 Virginia & Phil Chitwood  
 Tom & Beth Cleland  
 Charlie Collins & Ute Collins  
 Bill & Betty Connor  
 Bob & Jo Critchlow  
 Carla Schipper Cummings  
 Bailey & David Cunningham  
 Philip Cunningham  
 Gloria Cutter  
 Rick & Diane Davidson  
 Richard & Patricia De La Chapelle  
 Marilyn & Gene Derig  
 Bill & Holly Dietrich  
 Paul Dinnel & Vicki McNeil  
 Andrea Doll  
 Ann Dursch  
 Diane Eiesland  
 Elliot Staatz  
 Phil Elverum  
 Blair & Stacey Estenson  
 Marc & Pam Estvold  
 Bruce & Margaret Evertz  
 Nick Fahey & Deborah Martin  
 Cliff & Johanna Finkbohner  
 Dan & Beth Folkers

Lin Folsom  
 Greg & Leslie Ford  
 Jim Ford  
 Kecia Fox & Brian Adams  
 Michelle Fremont & Jerome McCool  
 Arlene & Bill French  
 Mica Gael & Bharat Gael  
 Mike Gaitley & Mike Dragovich  
 Judy Garnett  
 Ed & Carolyn Gastellum  
 Yale & Sheila Gifford  
 Barbara Gilmore  
 Kay Glade  
 H. A. Green  
 Ronald Grose  
 Scott Gudmundsen  
 John & Gerri Gunn  
 David Gurney  
 Walter & Susan Guterbock  
 Dr. Morgaine Hager  
 David & Deborah Hall  
 Ramona Hammerly  
 Lynda Harper & Ruth Thomas  
 Terry & Laura Hartnell  
 Ron Haywood & Leanne Lunsford  
 Haywood  
 Helen Heneks  
 Michael & Carol Herbert  
 Jan Hersey & Jay Ham  
 Sherry Hill  
 Harriet Hoffman  
 Sara Holahan  
 Bob & Ann Hostler  
 Sharon Howard  
 Everett Huff  
 John & Linda Hunt  
 Marcia Hunt  
 Nancy & Jerry Husted  
 Lisa Jackson  
 Tom & Wyndham Jackson  
 Dian & Steve Jahn  
 Dean Janz  
 Hershel & Bonita Janz  
 Wanda Jerit  
 Carl Johansen & Judy Chapman  
 Thomas & Lane Johnson  
 Doug & Sue Jones  
 Michael & Louanne Jones  
 Lynne Jordan & Dennis Clark  
 Hugh & Wendy Kendrick  
 Matt & Bonnie Kerschbaum  
 Tom & Robin King  
 Eugene & Barbara Kiver  
 Roland Kollodge  
 Rae Kozloff  
 Von & Betty Kuehn  
 Trevor & Carol Kyle  
 Terry & Sheryl Kylo

Diana Laiche  
 Carl & Karen Latham  
 Rick Latham  
 Tom Lebovsky & Jane Billinghurst  
 Bonnie & Tod Lehecka  
 E. Michael Lindsay-Jones  
 Mark Lioni  
 Sara & Tom Longworth  
 Janet Lowry & Jim Kirk  
 Mira Lutz & Matt Castle  
 Mary & Pat Lyons  
 Annette Macartney  
 Rick & Meredith Machin  
 Heather Macphail  
 Joan & Keith Magee  
 Deborah Martin  
 Lezlie & James Massey  
 John & Kim McCollister  
 Philip & Anne McCracken  
 Bruce & Kathleen McDanold  
 Myra McEwan  
 Forrie & Molly McIntosh  
 Dennis McMillan & Barbara Cooper  
 Sue Mehler  
 Robert C. & Barbara J. Meier  
 Judy & Gordon Middleton  
 Sheri Miklaski  
 Astrea Miller  
 Janet L. Miller  
 Jens Miller & Kerri Fredrickson  
 Margy Miller  
 W.M. Mike Mohundro  
 Andrea Webster Moore  
 Janet Moore  
 Dianne Moritz  
 Don & Cindy Morton  
 Kristen Murphy & Bob Vaux  
 Virginia Murphy  
 Kathy Nansel  
 Bob & Markay Neuman  
 Linda & Vance Nichols  
 Gwen & John Nixon  
 Grace Novicky & Tina Soes  
 Vera Oakes  
 Ranger Dave Oicles  
 Syd, Scott & Dave Olausen  
 Gabriel & Jeanne Olmsted  
 Curt & Monica Oppel  
 Leslie & Jon Ostlund  
 Maria Papritz  
 Susan Parke & Dederick Ward  
 Dena Petersen & Ann Buzaitis  
 Mary & David Picht  
 Andrew & Joan Pitz  
 Steve Purcer & Mary Campbell  
 Denny & Laurie Quirk

Brenda & Larry Ramsdell  
 Valerie Reuther  
 Cynthia & Jack Richardson  
 Dave & Nancy Ridgway  
 Betty Rockwell  
 Carol & Curt Rodin  
 Corinne & Art Salcedo  
 Gary & Bernie Santiago  
 Dennis & Nancy Schafer  
 Gene & Miriam Schroeder  
 Charlie Schultz & Terri Bakke  
 Schultz  
 Katherine Scott  
 Dan Senour  
 Bob Shelly & Patricia Wasson  
 Norma Sherin  
 Richard & Sue Sigmen  
 James & Mary Sikkema  
 J. Allen Smith  
 Terri Sommers  
 Laura & Paul Spehar  
 Charles Stavig & Jan Conklin  
 Stavig  
 Todd & Georgia Stewart  
 Charlene & Wayne Stoner  
 Richard & Daphne Storwick  
 Margaret Studer  
 Maggie Sullivan  
 T. Robert & Sandra Talbot  
 Cecil & June Thomas  
 Jim & Gina Thompson  
 Lyle & Carla Tiberghien  
 Jack & Sarah Tobien  
 Anna & Torolf Torgersen  
 Dale Ann Trafton  
 Gina Van Hess  
 Tom & Jean Vicary  
 Jane Wagner & Bruce Bollert  
 Thad & Helga Wakeman  
 Craig & Jeanne Wallin  
 Rosemary & Marvin Walter  
 Daniel Walters  
 Barton Waring  
 Bob & Judy Weathers  
 Steve & Lynne Webb  
 Regan Weeks & Scott Petersen  
 Mark Wenzel  
 Ron & Jan Wesen  
 E. Valerie White  
 Clay Wilcox  
 Dave Witiak  
 Chris & Jeff Wood  
 Ish Wood  
 Bob Woods & Lynnette Setmire  
 Mark F. & Constance Wray  
 Philip & Carolynne Wright  
 Family Yost  
 Rob Zwick

## Business, Organization and Foundation Members & Contributors

Anacortes Health and Nutrition  
 Anacortes Kayak Tours  
 Anthony's Restaurants  
 Autumn Leaves Bed & Breakfast  
 Azusa Farm and Gardens, LLC  
 Barrett Financial, Ltd.  
 Cimarron Trucking Inc.  
 Charlie & Ute Collins, DDS  
 Emerald Marine Carpentry  
 Fidalgo Animal Medical Center  
 Fidalgo Island Rotary Club  
 Gere-a-Deli  
 Global Diving & Salvage, Inc.  
 How It Works  
 Kiwanis Noon Club  
 Gerry Wallrath Fund  
 McMullen & Ochs, Attorney at Law  
 Island Import Garage  
 North Harbor Diesel  
 Northern Stone Supply  
 Port of Anacortes  
 Samish Indian Nation  
 Sebo's Hardware  
 San Juan Marine Freight Co. LLC  
 Shell Puget Sound Refinery  
 Skagit Community Foundation  
 Skagit Runners  
 Soroptimist International of Anacortes  
 Strandberg Construction, Inc.  
 The Runstad Foundation  
 Watermark Book Company  
 Windermere Real Estate, Anacortes  
 Mark & Constance Wray Family  
 on behalf of The Harry F. Barnes  
 and Carol H. Barnes Family  
 Foundation

## Memorials

We wish to acknowledge a donation from David and Deborah Hall in memory of Michael Herbert and a donation from Gene and Marilyn Derig in memory of Bill Folmer.

## Gifts

A donation was made in honor of Malcolm and Michelle McPhee by Jack and Sarah Tobien.

*Please let us know if your name is missing, misspelled or if you prefer to be listed differently.*



**FRIENDS OF THE ACFL**

P.O. BOX 2213

ANACORTES, WA 98221

Non-Profit Org.  
U.S. Postage  
**PAID**  
Anacortes, WA  
Permit #42

Printed by



**ANACORTES  
PRINTING**

*Save the Date!* Our Annual Benefit event will be on November 1st, 2014.



## Friends of the Anacortes Community Forest Lands

### MEMBERSHIP FORM

The Friends of the Forest is a nonprofit, citizens organization dedicated to the preservation of the Anacortes Community Forest Lands through education, outreach and stewardship. *Friends of the Forest is a not for profit 501 c3 organization. Tax ID # 501c3 91-1430220*

**PLEASE JOIN US!** Membership and contributions are tax-deductible.

Name \_\_\_\_\_ Phone \_\_\_\_\_ Email \_\_\_\_\_

Address \_\_\_\_\_



Membership Renewal



New Member

We offer many levels of annual membership dues. Please choose your level of support for this vital mission in our community.

Annual dues: ☐ Individual \$25 ☐ Family \$40 ☐ Partner \$50 ☐ Supporter \$100  
☐ Sponsor \$250 ☐ Benefactor \$500 ☐ Steward \$1000 ☐ Major Donor \$5000 or more  
Other \_\_\_\_\_

Areas of Interest \_\_\_\_\_ Topics for general meetings or newsletter \_\_\_\_\_

Please mail memberships/contributions to: Friends of the ACFL, P.O. Box 2213, Anacortes, WA 98221 or visit us at 611 R Avenue, Anacortes, WA 98221

Thank you to all friends who have renewed their dues and a reminder to those who haven't sent in this year - we need it! Keeping your dues current with the Friends of the Forest is one of the best ways to Think Globally and Act Locally. On Fidalgo Island, thankfully we have the ACFL, and it needs Friends to ensure its preservation. Our Education Program depends on your support. Thank you!